

# Construction Update: Sept. 7, 2021

Nighttime road closures on Highway 111 **CANCELED**.  
New traffic pattern on Avenue 66 near Lincoln Street Wednesday night.

## New Traffic Pattern on EB Avenue 66 near Lincoln Street

- Wednesday night.  
Sep. 8 | 7 p.m. to 4 a.m.



Please watch for trucks entering and exiting at multiple locations.  
Closures may change due to weather and field conditions.

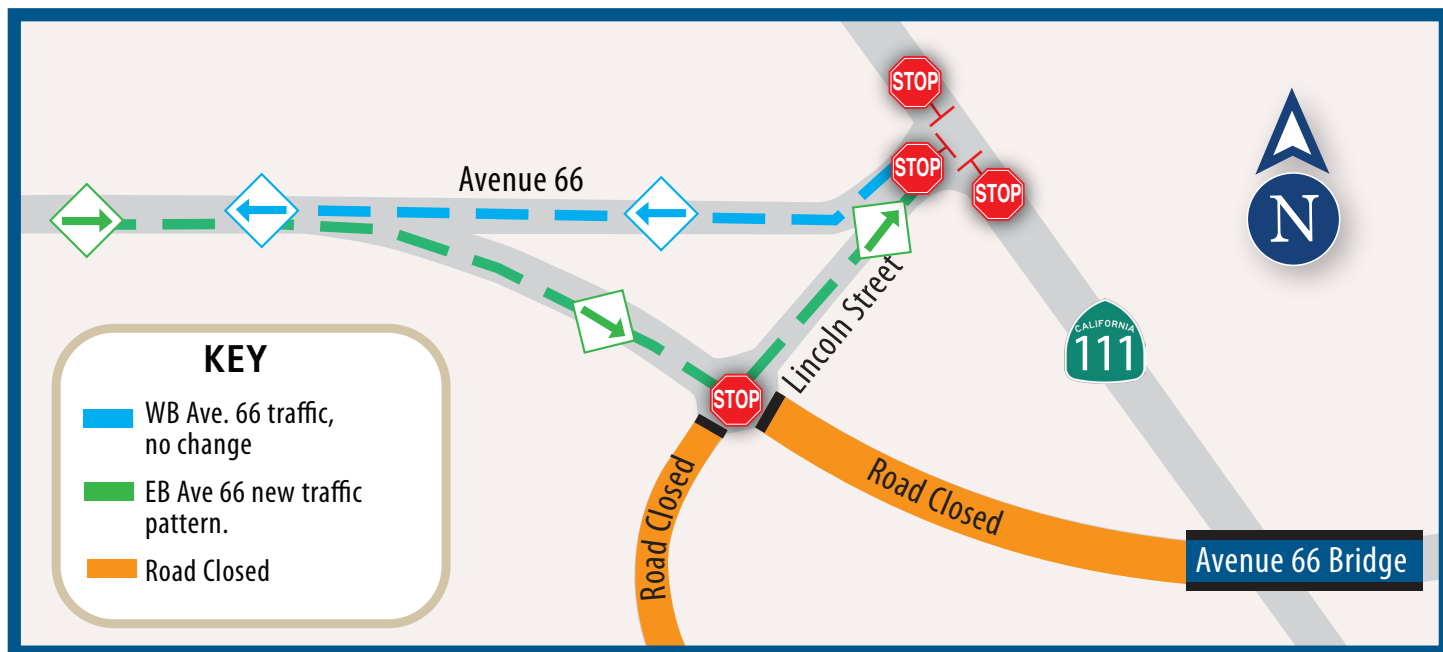

On eastbound Avenue 66, motorists will travel onto the newly built road that connects with Lincoln Street and the Avenue 66 bridge. Stop signs will be in place and traffic will turn left onto the new Lincoln Road, then connect with Highway 111 to travel north or south. Southbound Lincoln Road and the new road to the bridge remain closed.

This is a temporary traffic change while the intersection and the traffic signal at the new road and Lincoln Street is completed.

Sign-up to receive  
English/Spanish email or text updates at  
877.283.0066 | #Ave66   

[Ave66project.com](https://Ave66project.com)

